

PROPOSED 1:50  
(TOTAL GIFA 92.6m²)

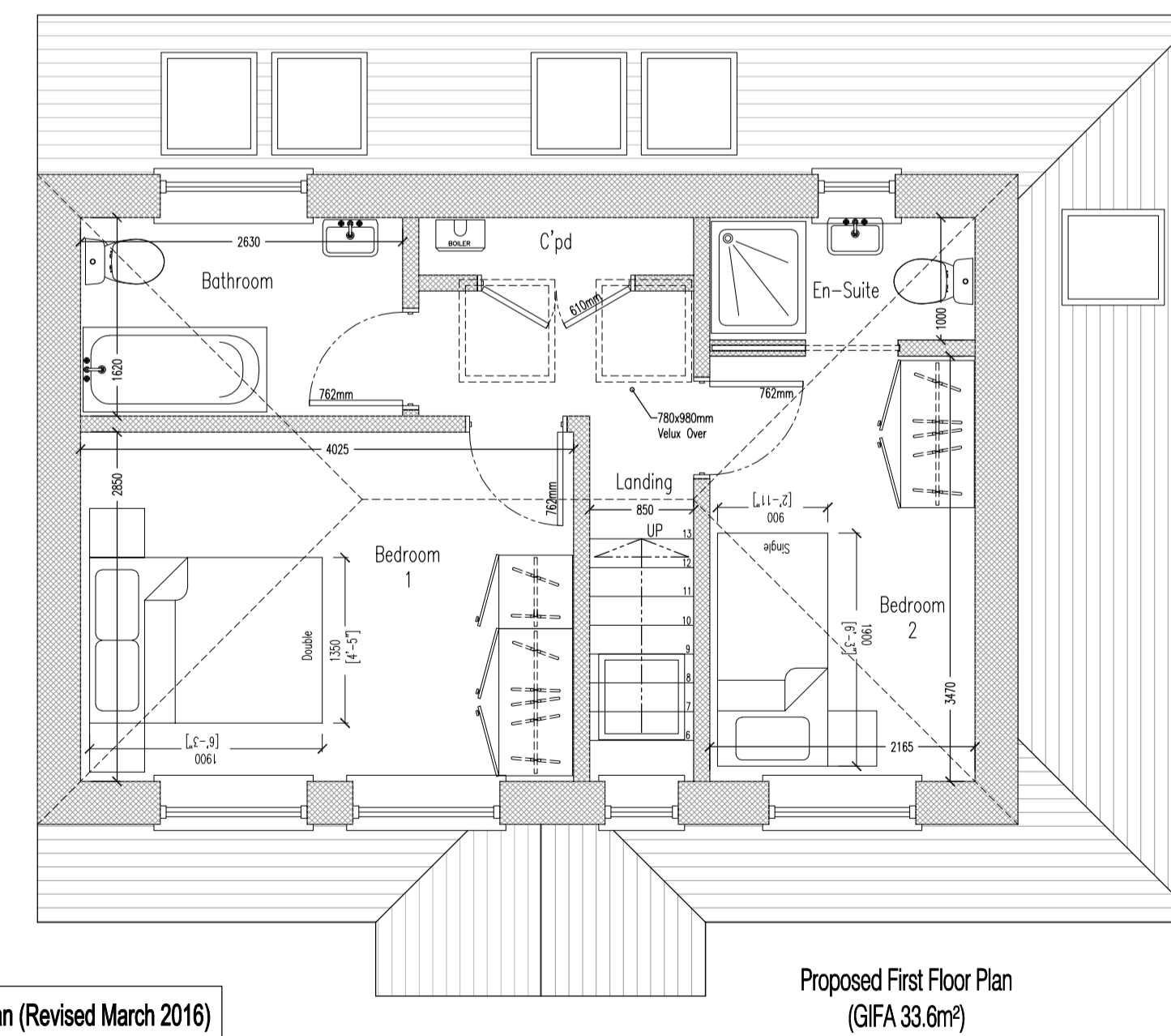

The Proposed New Dwelling will Fully Comply with The London Plan (Revised March 2016)  
 1) Minimum Dwelling Space Standards  
 2) Max 105 Litres Water Consumption Per Person Per Day  
 3) Building Regulations for Accessibility & Adaptability (Part M4(2))

P2	JB	Detailed Added	12/4/19
P1	JB	Issued for Comment	1/3/19
Rev:	Description:	Date:	
1/3/19	Scale @A1:	1:50/100	

Project:  
 169 Rowley Avenue  
 Sidcup  
 DA15 9LQ

Title:  
 Proposed New Dwelling  
 -PLANNING DRG 2 of 2-

Drawing No:	Revision:
3253-18-PL202	P2

crofton design services limited

2-3 Rice Parade, Fairway,  
 Petts Wood, Kent. BR5 1EQ

01689 836855  
 design@croftondesign.co.uk  
 © CDS Ltd. 2019

www.croftondesign.co.uk

crofton design

