

Area occupied by Arco (Scale 1:200)

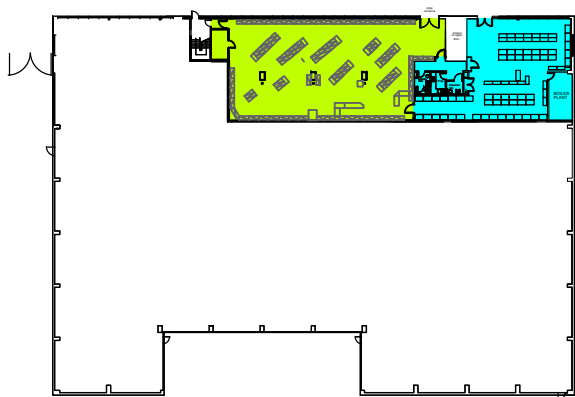

Location of Arco Trade Counter within building footprint (NTS)



ESTATES DEPARTMENT  
 P.O. BOX 21  
 WAVERLEY STREET  
 HULL HU1 2SJ  
 Tel.no. (01482) 222522 Fax no. (01482) 611585

Branch: **Arco Ltd, Cray Avenue, St Mary Cray,  
 Orpington, BR5 3QB**

|               |                |
|---------------|----------------|
| Drawing no.:  | ORPINGTON      |
| Revision no.: |                |
| Scale:        | As Shown       |
| Date:         | September 2012 |
| Drawn by:     | Estates        |