

Disclaimer
 This drawing should not be scaled.
 The contractor is to check all dimensions on site and inform the contract administrator/project manager of any discrepancies.
 All work is to comply in every aspect with the Building Regulations, Codes of Practice and British Standards.
 This drawing is to be read in conjunction with all other contract drawings and specifications.
 This drawing is copyrighted and must not be reproduced in any format or disclosed to any third party without the written consent of Tuffin Fenley Taylor LLP.

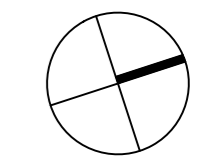

rev date details by

SAFETY, HEALTH AND ENVIRONMENTAL INFORMATION
IN ADDITION TO THE HAZARDS / RISKS NORMALLY ASSOCIATED WITH THE TYPES OF WORK DETAILED ON THIS DRAWING, NOTE THE FOLLOWING:
CONSTRUCTION
MAINTENANCE / CLEANING / OPERATION
IT IS ASSUMED THAT ALL WORKS MUST BE CARRIED OUT BY A COMPETENT CONTRACTOR WORKING, WHERE APPROPRIATE, TO AN APPROVED METHOD STATEMENT
▲ SIGNIFICANT HAZARD
▲ HAZARD
CHECKED BY:

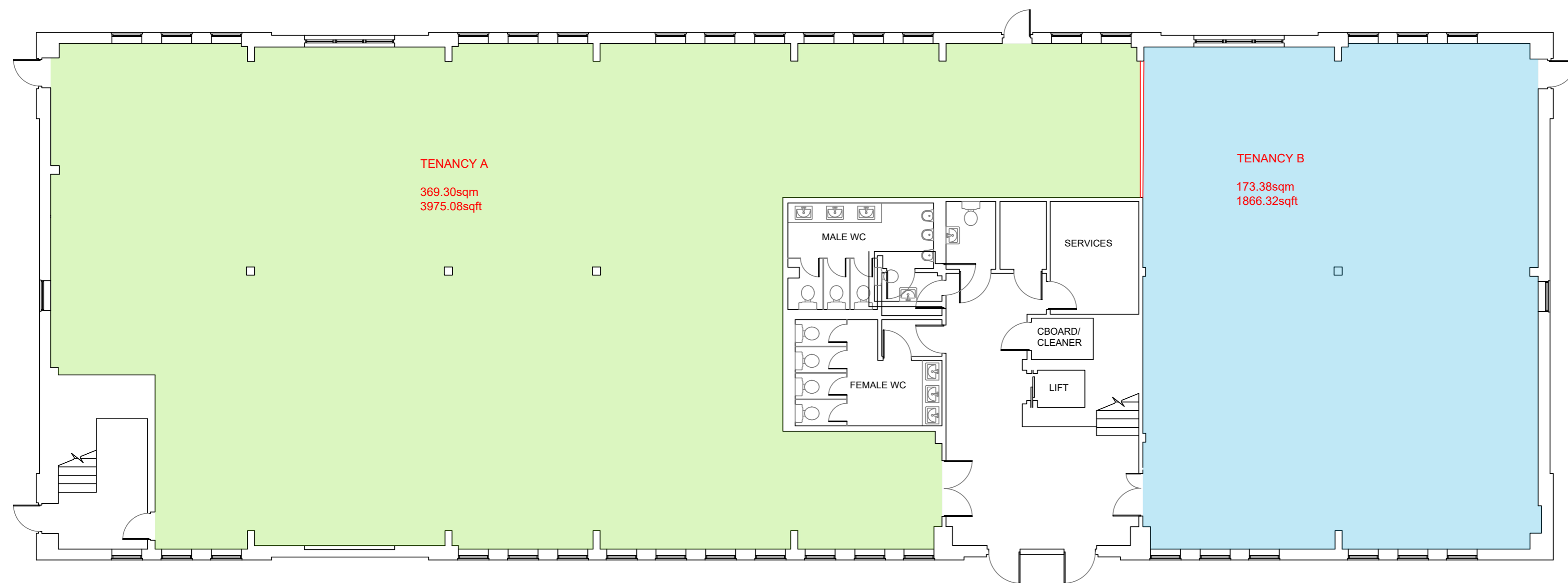

Ground Floor Plan.

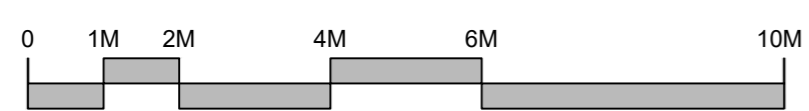

SCALE 1:100

CLIENT L&G
 PROJECT Ground Floor, Osprey House, Crayfields Business Park, BR5 3QJ SCALE A2 1:100
 DRAWING Ground Floor Plan - Proposed Demise Areas - Option 6 DATE Nov 2021



PROJECT No. 210045 DRAWING No. P02_6 REV

www.tftconsultants.com